

C.S.S.A.

Two Men in Jericho

RAHABS HOUSE

THE FOLLOWING EXAMPLES OF HOUSES MADE FROM BOXES WILL PROVE TO BE USEFUL FOR MANY A FUTURE LESSON.

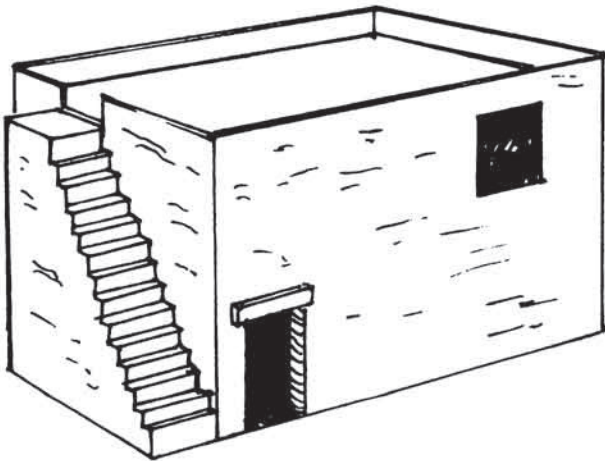

MATERIALS REQUIRED.

CARDBOARD BOX ANY REASONABLE SIZE ● SHARP CRAFT KNIFE ● WHITE PAINT (CEILING PAINT OR SIMILAR MATT FINISH WHITE) ● SAW DUST.

HOW TO MAKE IT.

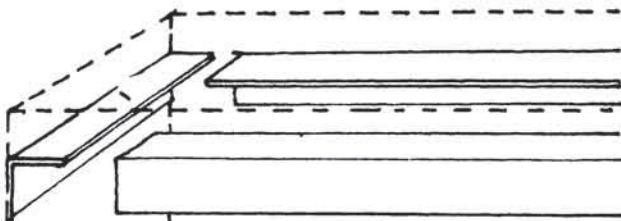

CUT THE TOP FLAPS OFF THE BOX AND USE THEM BY CUTTING INTO STRIPS, BENDING IN HALF AND GLUING THEM ONTO THE INSIDE OF BOX TO USE AS A

BASE FOR THE REMOVABLE ROOF.

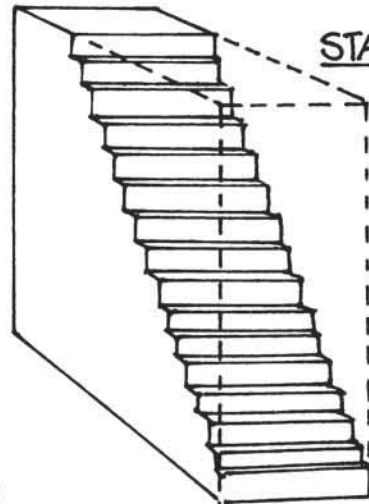

STAIRS

CUT FROM A BLOCK OF Balsa WOOD. GLUE ONTO THE SIDE OF THE BOX.

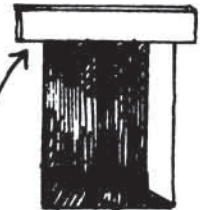

DOOR LINTEL. MAKE FROM STRIP OF CARDBOARD FROM BOX.

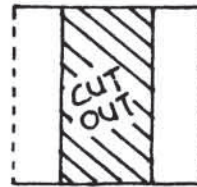

CUT OUT

DOOR - CUT OUT ALONG LINES AND FOLD BACK ALONG DOTTED LINES TO GIVE THE LOOK OF A THICK WALL.
WINDOW - CUT OUT SQUARE WITH SHARP KNIFE.

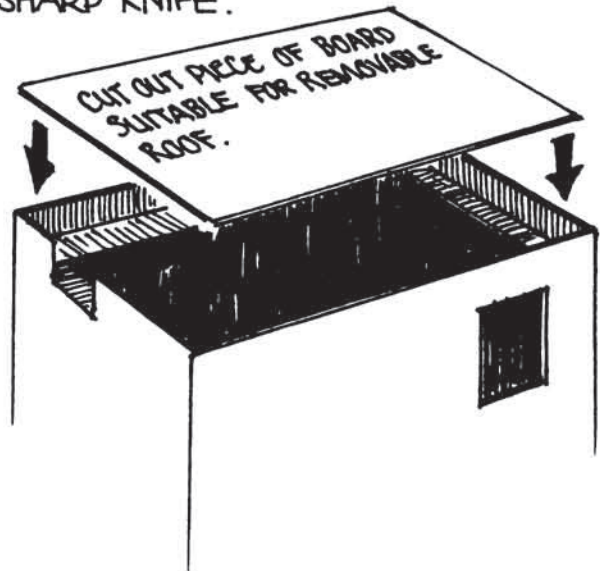

CUT OUT PIECE OF BOARD SUITABLE FOR REMOVABLE ROOF.

TO GIVE THE 'HOUSE' A WHITEWASHED PLASTER LOOK, PAINT ON A MIXTURE OF WHITE PAINT AND SAWDUST. IF YOU ARE REALLY AMBITIOUS, TRY APPLYING A THICK CREAMY MIXTURE OF PLASTER INSTEAD.

CLASS ACTIVITY.

TO TELL THE STORY OF RAHAB AND THE SPIES, PLACE SOME GRASS OR STRAW ON THE ROOF OF THE HOUSE. TAPE A PIECE OF RED STRING OR WOOL TO THE INSIDE OF HOUSE SO THAT THE STRING CAN BE LET DOWN FROM THE WINDOW. FOR FIGURES DEPICTING THE CHARACTERS IN THE STORY SEE DIRECTIONS A FEW PAGES ON.

CITY WALL HOUSE

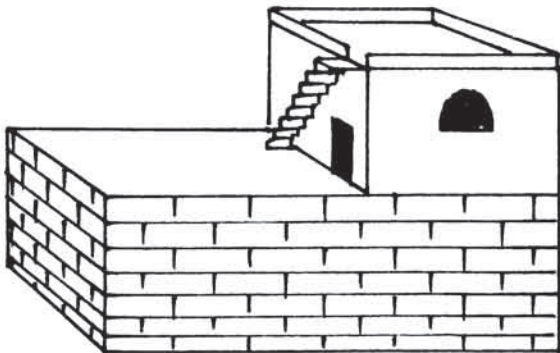

MATERIALS REQUIRED.

BOX HOUSE AS ON PREVIOUS PAGE OR SIMILAR HOUSE MADE FROM A BOX ● LARGER BOX, TO BE USED AS A CITY WALL ● BROWN PAPER ● GLUE ● SCISSORS ● FELT TIP MARKER.

HOW TO MAKE IT.

TURN BOX UPSIDE DOWN AND COVER WITH BROWN PAPER. DRAW BRICKS IN WITH FELT TIP MARKER OR CRAYONS. PLACE THE CARDBOARD HOUSE ON THE WALL AS IN THE SKETCH ABOVE. A CITY GATE CAN BE ATTACHED TO THE SIDE OF THE BOX, FROM ANOTHER PIECE OF CARD.

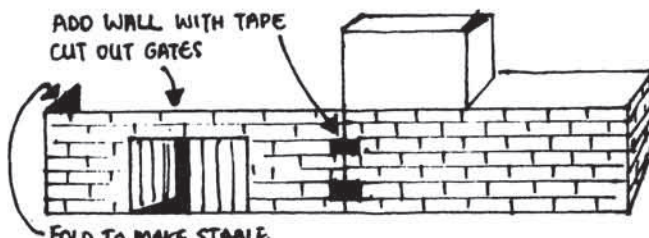

TAKE HOME TREATS

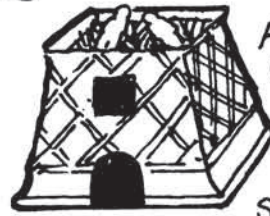

A SQUARE ICECREAM CONE UPSIDE DOWN WITH DOOR AND WINDOWS CUT OUT. 2 JELLY BABIES STUCK ON THE "ROOF"

WITH ICING SUGAR AND SHREDDED COCONUT FOR "FLAX".

HOW ABOUT 2 JELLY BABIES COMING DOWN A LICORICE STICK.



PUT SOME STRAW IN THE BOTTOM OF A MATCH BOX AND

PUT IN A FEW JELLY BABIES.

MAKING BIBLE FIGURES

THE FOLLOWING EXAMPLES OF BIBLE FIGURES AND HOW TO MAKE THEM, WILL PROVE TO BE INVALLABLE IN THIS LESSON AND OTHERS THAT WILL FOLLOW.

PIPE CLEANER FIGURES

MATERIALS REQUIRED.

● PIPE CLEANERS ● SCISSORS ● PAPER ● GLUE OR CLEAR STICKY TAPE.

HOW TO MAKE IT

LOOP TWO PIPE CLEANERS TOGETHER AS IN (A) TWIST THE LOWER WIRE TO FASTEN TOP LOOP AND TO FORM LEGS AS IN (B) TO MAKE FIGURE STAND, TAPE OR GLUE TO A SQUARE PIECE OF CARD.

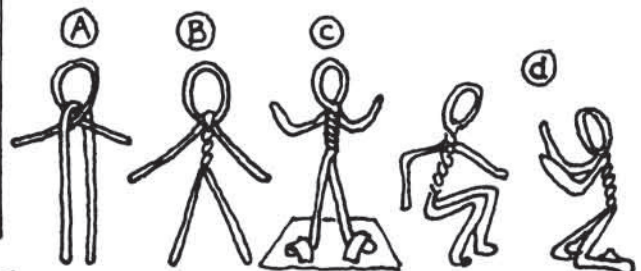

HEADS FOR PIPE CLEANER FIGURES.

MATERIALS REQUIRED.

PIPE CLEANER FIGURES ● LARGE WOODEN BEADS ● LARGE FLAT BUTTONS. ● PAPER ● SCISSORS ● GLUE ● COLOURED PENCILS ● POSTER PAINTS AND BRUSHES. ● COTTON ● NYLON STOCKING ●

HOW TO MAKE THEM.

HERE ARE A FEW DIFFERENT WAYS TO MAKE HEADS FOR PIPE CLEANER FIGURES.

1. DRAW A SMALL CIRCLE ON PAPER. DRAW IN THE FACE AND HAIR. CUT OUT AND GLUE ONTO LOOP OF FIGURE. (A)
2. BEFORE MAKING FIGURE, THREAD THE HEAD AND ARM WIRE THROUGH A LARGE WOODEN BEAD. ADD THE SECOND WIRE AND TWIST TO MAKE FIGURE AS IN (B & C) PAINT FACE OR DRAW ON WITH FELT PEN. GLUE ON WOOL, FOR HAIR.
3. GLUE LARGE BUTTON TO HEAD LOOP OF FIGURE. PAINT OR DRAW ON FACE. GLUE ON WOOL FOR HAIR. (D)
4. ATTACH A SMALL BALL OF COTTON WOOL TO THE HEAD LOOP. COVER WITH A SMALL PIECE OF NYLON STOCKING AND FASTEN AT THE NECK WITH A THREAD. PAINT THE FACE OR EMBROIDER. (E)

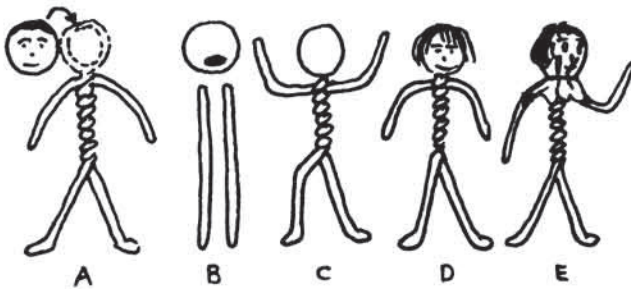

CLOTHES FOR PIPE CLEANER FIGURES.

MATERIALS REQUIRED.

● PIPE CLEANER FIGURES ● SCRAPS OF MATERIAL ● TISSUES ● THREAD ● GLUE.

HOW TO MAKE IT.

CUT A TISSUE IN HALF. SLIT ONE PIECE LENGTHWISE TO CENTRE AND

PLACE ON THE FIGURE AS IN (A) FOLD OVER, GATHER AROUND WAIST AND TIE WITH THREAD OR A THIN STRIP

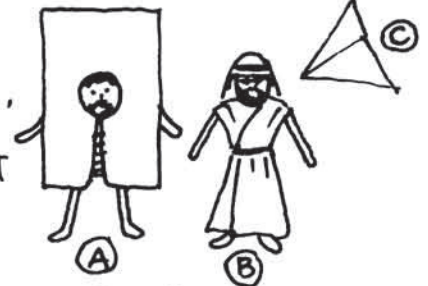

OF TISSUE WHICH CAN BE GLUED AT THE BACK. (B). THE HEAD-DRESS IS MADE BY CUTTING A SQUARE PIECE OF TISSUE AND FOLD INTO A TRIANGLE (C) AND ATTACH TO HEAD WITH THREAD. THIN MATERIAL MAY BE USED INSTEAD OF TISSUE.

CLOTHESPEG FIGURES.

MATERIALS REQUIRED.

● CLOTHES PEGS AS THE TYPE ILLUSTRATED BELOW. ● COTTON WOOL ● PIPE CLEANERS ● SCRAPS OF CLOTH ● NYLON STOCKINGS OR SCRAP OF WHITE SHEET, POSTER PAINTS AND BRUSHES ● NEEDLE & THREAD ● SCISSORS. CARDBOARD 15cm x 1.5cm.

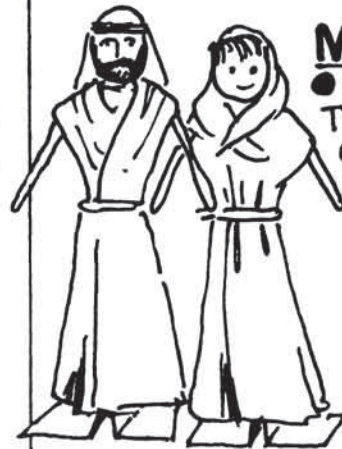

HOW TO MAKE IT.



FOLD CARDBOARD STRIP TO MAKE A STAND FOR FIGURE (A) PAD THE CLOTHESPEG HEAD



WITH A BIT OF COTTON WOOL & COVER WITH A SCRAP OF NYLON OR SHEET. WRAP PIPE CLEANER AROUND THE NECK TO HOLD THE HEAD IN PLACE AND FORM THE ARMS (B) PAINT OR EMBROIDER FACIAL FEATURES. ADD WOOL OR YARN FOR HAIR. MAKE ROBE

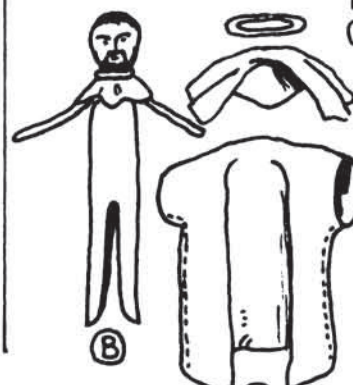

BY CUTTING A PIECE OF CLOTH 6.5cm x 15cm. FOLD IN HALF TO 7.5cm x 6.5cm. AND CUT AS IN (C). TURN ROBE INSIDE OUT AND SEW UP SIDE OF SEAMS. TURN RIGHT SIDE AND PRESS. PUT ROBE ON DOLL

AND TIE ABOUT THE WAIST WITH WOOL OR YARN. FOR HEADDRESS CUT A PIECE OF CLOTH 7cm SQUARE. FOLD INTO A TRIANGLE. TIE ONTO HEAD WITH WOOL. A WOMANS DRESS MAY BE MADE IN THE SAME WAY. HER HEADDRESS SHOULD BE FOLDED LOOSELY OVER SHOULDERS AS IN DRAWING OF FINISHED FIGURE ON PREVIOUS PAGE.

TAKE HOME MODEL

A MINIATURE MODEL OF RAHAB'S HOUSE CAN BE MADE BY MAKING UP THE OUTLINE BELOW OR BY PHOTOCOPYING. A SERIES OF THESE COULD BE USEFUL IN DEPICTING MANY LESSONS WHICH INVOLVE VILLAGES AND CITIES. IF AN EXTRA ROOM IS REQUIRED FOR THE ROOF, USE THE UPPER HOUSE PATTERN ON THE LEFT AND GLUE ONTO TOP OF LOWER HOUSE.

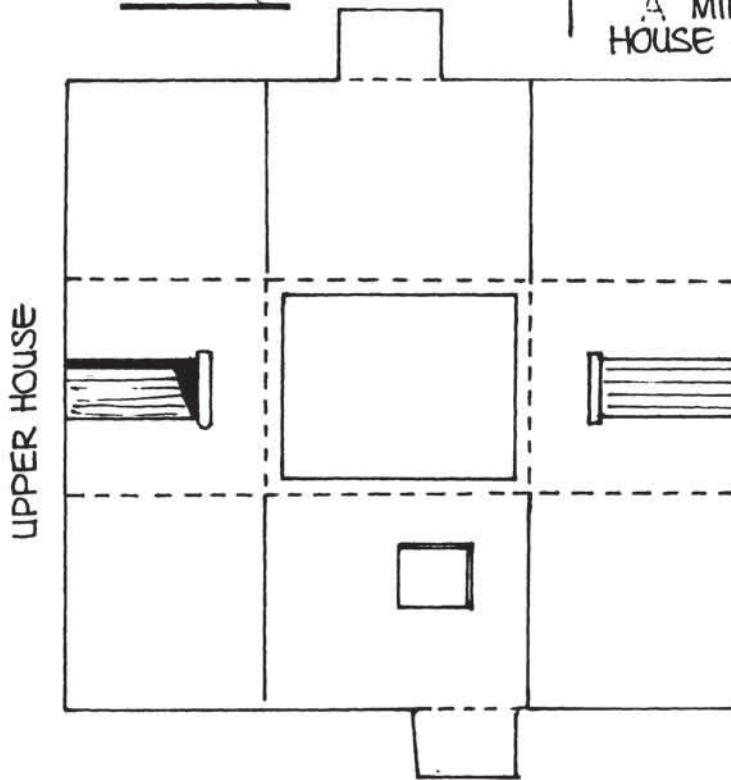

CUT ON SOLID LINES

FOLD ON DOTTED LINES.

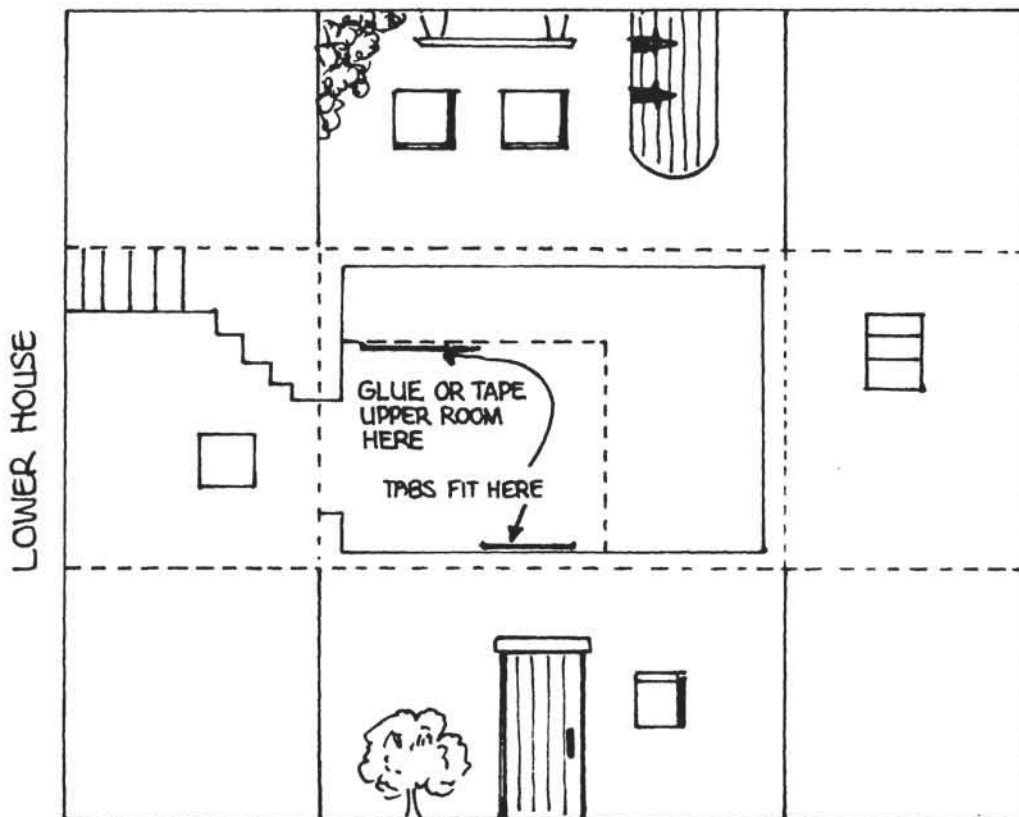

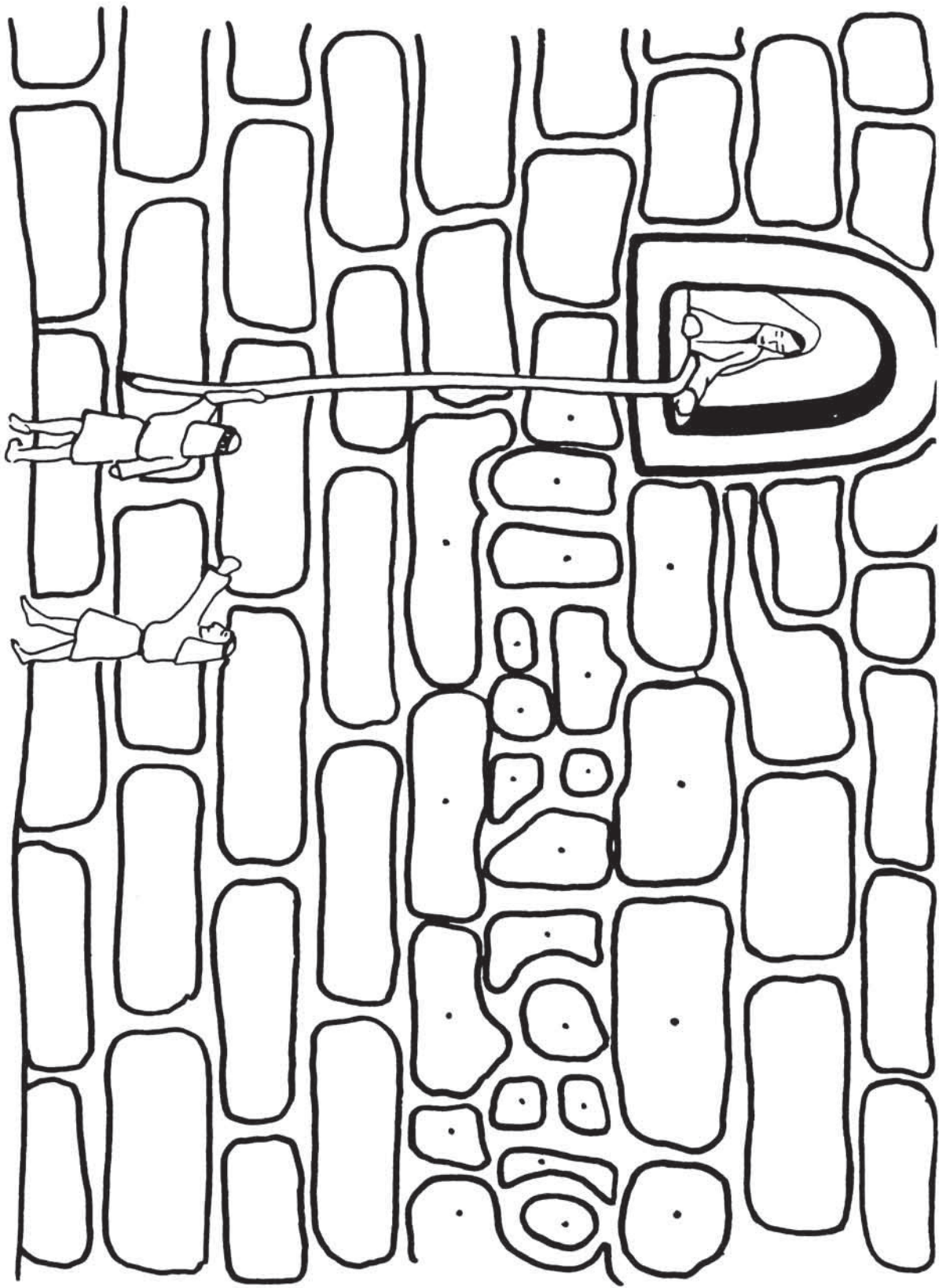

COLOUR IN WITH LEAD PENCIL THE BRICKS WITH A DOT IN THEM , TO FIND OUT THE NAME OF THE CITY. COLOUR THE REST OF THE PICTURE .

PHOTOCOPY THE ABOVE AND GIVE TO CHILDREN DURING THE CLASS OR TO TAKE HOME.